



# AHBA TRIAL



HALLOWEEN

GOBLINS & GHOULS

**OCT. 20, 21, & 22, 2017**

**Herding Ranch Dog (HRD) Trial  
&  
HTD & HTAD Ducks**

**Other AHBA Trial Dates:**

Nov. 17-29, 2017

Feb. 9-11, 2018

Mar. 16-18, 2018

Oct. 26-28, 2018

Nov. 16-18, 2018

**Information, Course Layout and Entry Forms:**

Barbara (253) 732-5959  
k9sayno@aol.com

or

Elsie (360) 785-0831  
elrhodes2@msn.com

## Friday, October 20

Non-competitive only! Scores will count toward titles, no placing or awards.  
Limited to after the course has been set up. You **MUST** pre-enter so we can plan accordingly.

### Classes & Limits

Sheep, Herding Ranch Dog (HRD) - I, II, III .....25 runs  
Ducks, Herding Trial Dog (HTD) - I, II, III..... Ducks combined HTD & HTAD 18 total runs  
Ducks, Herding Trial Arena Dog (HTAD) - I, II, III..... Ducks combined HTD & HTAD 18 total runs

### Course Description and Information

HRD: Directions and course layout on the following pages.

HTD Ducks: HTDI-60 foot outrun HTDII/ HTDIII-100 foot outrun, 60 foot drive/fetch legs, shed

HTAD Ducks: Course 2, take pen, shed

### Entry Fees

Ducks - HTD & HTAD..... \$35.00  
Sheep - HRD.....\$50.00  
Junior Handler..... 1/2 entry fee  
Day of Entries... (Add \$5.00 per entry if runs are still available)... 7:30a.m. – 8:00a.m.

### Entries

#### Pre-entry (on or before 10/13/17)

Send pre-entries and make money orders or checks payable to:  
Elsie Rhodes, 119 Reinseth Rd. Winlock, WA 98596-9326

### Judges

October 20	HRD sheep – Barbara Davenport	HTD & HTAD ducks – Elsie Rhodes
October 21	HRD sheep – Connie Reed	HTD & HTAD ducks – Barbara Davenport
October 22	HRD sheep – Mary Peaslee	HTD & HTAD ducks – Elsie Rhodes

### Awards

Rosettes.....1<sup>st</sup> – 4<sup>th</sup> place  
Saturday & Sunday..... Reserve High in Trial, High in Trial  
High Combined.....Scores from all classes on Saturday & Sunday are totaled

### Motels & Camping

**Relax Inn** (Off I5 at Exit 76) 550 S. Parkland Dr., Chehalis, WA (800) 843-6916 or (360) 748-8608  
**Chehalis Inn** (Off I5 at Exit 76) 122 Interstate Ave., Chehalis, WA (877) 740-5330 or (360) 740-5339  
**Oak RV Park** (Off I5 at Exit 68) 118, US Hwy 12, Chehalis, WA (360) 262-9991  
**Rivers Edge Lodge & RV Park** (Off I5 exit 59) 162 Cowlitz Loop, Toledo, WA (360) 864-8111  
Camping on site for a limited number of RVs – no hook ups – please contact Elsie about space

### Food

Lunch - Saturday and Sunday: \$8.00 with entries so we can plan accordingly.  
Restaurants: in the city of Winlock, 4 miles from trial site.

### Location and Directions

119 Reinseth Rd., Winlock, Washington

Interstate 5 to **Exit 63**; turn West, toward Winlock, travel ½ mile to **South Military Rd.**, turn left;  
travel 2.2 miles to **Nikula Rd.** turn right; travel 1 ½ miles to **Reinseth Rd.** turn right; **Second home on the left.** Frog's Breath Farm has a light green manufactured home.

# Frog's Breath Herding Ranch Dog Trial Sheep (HRDs)

## October 20, 21, 22, 2017

### STARTING SET UP:

- Livestock will be held in adjoining Fields and Pens without visibility screens.
- The course will begin and must end with five sheep in Pens E, G, I, J and the Round Pen. All groups of sheep will be marked so they are identifiable as a set.
- All gates will be closed.

### GENERAL RULES:

- Time 20 minutes.
  - All elements must be attempted prior to moving on.
  - Sheep will be held off all gates while the gate is being opened except for the sort in Pen I.
  - Exercise "1. Small Pen Work," will break ties. 2<sup>nd</sup> tie breaker will be exercise "3. Drive and Obstacle 1." 3<sup>rd</sup> tie breaker will be Time.
1. **SMALL PEN WORK - 25 pts.:** Time begins when the gate into Pen K is opened. Move the sheep from Pen J into Pen K; move the sheep from Pen I into Pen J; move the sheep from Pen G into Pen I; move the sheep from Pen E into Pen I; move the sheep from the Round Pen into Pen E. Dog and Handler will now enter Pen I. Exercise ends when the gate into Pen I is closed.
  2. **SORT - 10 pts.:** Exercise begins when the gate into Pen I is closed. Gate sort the sheep you removed from Pen E into Pen G. The exercise ends when the gate between Pens I and G is closed.
  3. **DRIVE, OBSTACLE 1 - 25 pts.:** The exercise begins when the gate between Pen I and G is closed. Using the alleyway go into Field 5. Remove the sheep from Pen K. Drive them across Field 5, through Obstacle 1 and then behind the panels next to the road. Leave the sheep behind these panel. The exercise ends when the sheep are behind the panel.
    - **HRD I** may accompany the sheep thought-out this exercise.
    - **HRD II** stays in the marked area until the sheep have been moved through or passed Obstacle 1. The Handler may move once the sheep clear Obstacle I or have passed it.
    - **HRDIII** Handlers will remain in the marked area through-out this exercise.
  4. **GATHER - 15 pts.:** Exercise begins when the sheep are behind the panels. The Dog will be called off the stock. Handler will position the Dog for the Gather from the area for their level. Send the Dog to gather the sheep. Move the sheep into the marked Handler's area then move the sheep into Field 3. Both Dog and Handler move into Field 3 before closing the gate. The exercise ends when the gate between Fields 3 and 5 is closed.
    - **HRD I** the Dog will be positioned no closer than the panels for Obstacle 1. The handle may move to within 15 ft. of the sheep and may accompany Dog and sheep as they are moved through the course.
    - **HRD II** the Dog will be positioned within the marked Handler's area. The Handler may move to Obstacle 1. Once the sheep have passed the Handler on the gather the Handler is free to move.
    - **HRD III** the Handler will remain at within the marked Handler's area throughout the gather.
  5. **REPEN HRD I & HRD II - 15 pts.; HRD III only - 25 pts:** Exercise begins when the gate into Field 3 is closed. Collect the sheep move them to the east side gate into 12 ft. alleyway into the Round Pen. Time ends when the gate to the Round Pen is closed.
    - **HRD III** - only will put the sheep through Obstacle 2.

# Frog's Breath Farm Herding Ranch Dog Sheep Trial (HRDs) October 20, 21, 22, 2017



Fields:  
3. 100' X 100'  
5. 170' X 218'

Pens:  
E. 22' X 79'  
G. 34' X 43'  
I. 35' X 43'  
J. 30' X 43'  
K. 35' X 43'  
Round Pen 65' diameter

Alleys:  
6' X 179'  
12' X 86'

1. SMALL PEN WORK →
2. SORT
3. DRIVE & OBSTACLE 1 →
4. GATHER →
5. REPEN  
plus  
HRD III ONLY  
OBSTACLE 2 →



--- Obstacle 1

|| Obstacle 2  
HRDIII only

— Panel  
12 ft. off the fence

--- Handler's Area

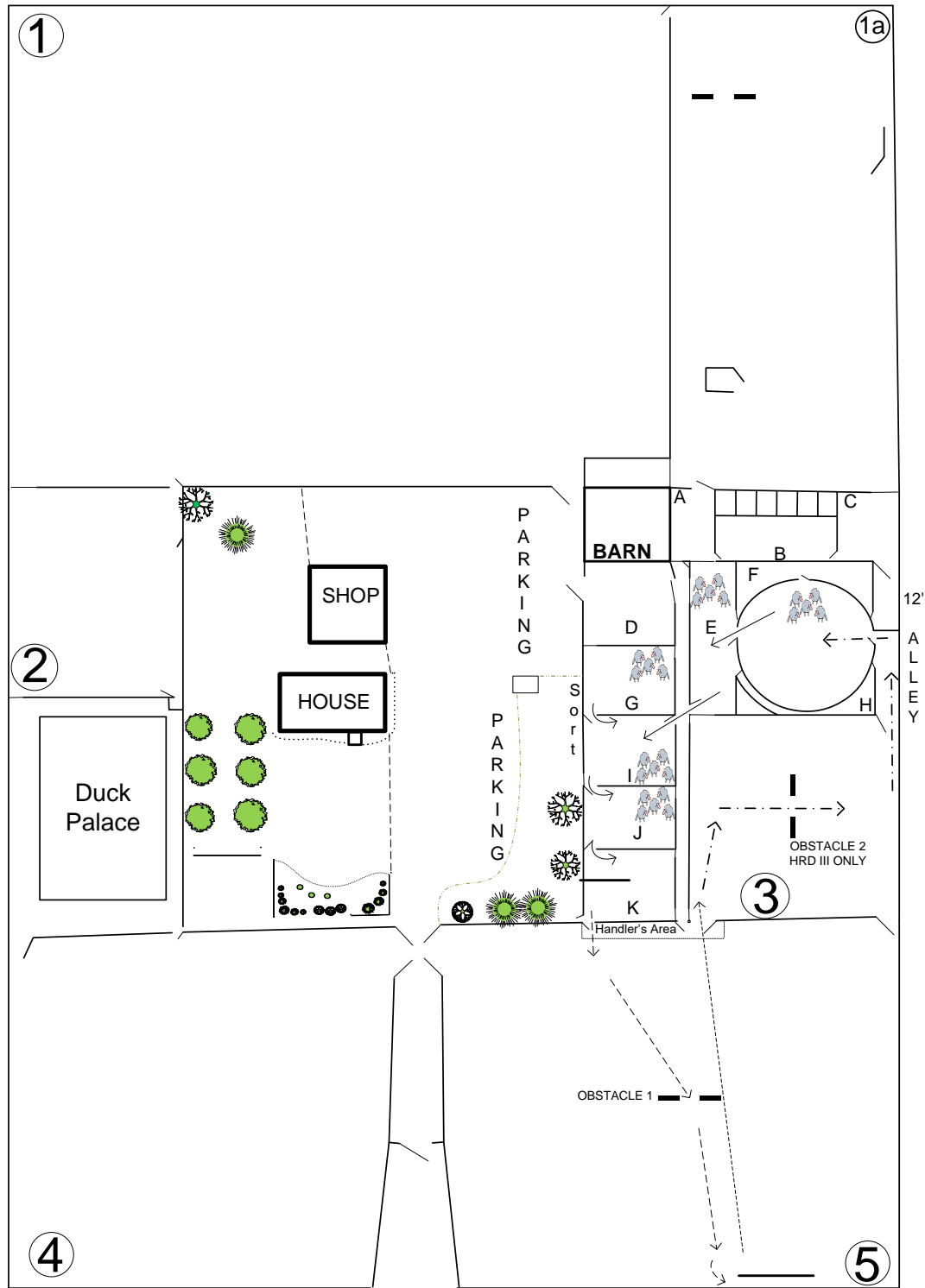

# Please fill out one entry form per dog.

Entry Number: \_\_\_\_\_

Reg. Name: \_\_\_\_\_

Call Name: \_\_\_\_\_ Breed: \_\_\_\_\_

DOB: \_\_\_\_\_ Sex: \_\_\_\_\_ Reg. No. \_\_\_\_\_ Registry: \_\_\_\_\_

Breeder: \_\_\_\_\_

Sire: \_\_\_\_\_

Dam: \_\_\_\_\_

Owner: \_\_\_\_\_

Address: \_\_\_\_\_

City: \_\_\_\_\_ State: \_\_\_\_\_ Zip: \_\_\_\_\_

Phone: \_\_\_\_\_ E-mail: \_\_\_\_\_

Name of handler if other than owner: \_\_\_\_\_

### Check Class(es) you are entering

	HRD SHEEP					HTD DUCKS					HTAD DUCKS							
Fri.		I		II		III		I		II		III		I		II		III
Sat.		I		II		III		I		II		III		I		II		III
Sun.		I		II		III		I		II		III		I		II		III

Pre-entry (received on or before 10/13/17)

HRD Sheep \$50.00      HTAD & HTD Ducks \$35.00      Jr. Handlers Pre-entry 1/2 price

Day of Entries. Add \$5.00 if runs are available.      Entries \$ \_\_\_\_\_

Lunch must sign up now \$8.00 per day. Number of lunches Sat. \_\_\_\_, Sun. \_\_\_\_      Lunches \$ \_\_\_\_\_

**Total entries & lunches \$ \_\_\_\_\_**

In consideration for participation in an event sanctioned by the American Herding Breed Association (AHBA), hosted by Barbara Davenport, Elsie Rhodes, and Frog's Breath Farm, I agree to assume all responsibility for any claim, loss or damage, of whatever kind or nature, whether to person or property, which may be caused at or near this event either directly or indirectly, by me or the dog or dogs I have entered in or brought to this event. I further agree that I will hold the AHBA, its officers, directors, agents, members, Barbara Davenport, Elsie Rhodes, Frog's Breath Farm their families and employees harmless and defend them from any and all liability for any injury, claim, damage or loss, of whatever kind or nature, whether to person or property, caused at or near this event. I agree to indemnify the AHBA, its officers, directors, agents, members, Barbara Davenport, Elsie Rhodes, and Frog's Breath Farm and their families and/or employees for any liability or obligation which may or does arise as a result of any claim(s), litigation, loss or damage caused in any way by any act or negligence on my part or on the part of any person, dog or dogs I have entered in or brought to this event. I acknowledge that while the AHBA may provide sanctioning and Barbara Davenport and Elsie Rhodes are hosting this event with regard to issuing of titles, they do not have, and do not exercise, control over the conduct of the event or those present. I certify and represent that the dog or dogs I have entered in or brought to this event is/are not a hazard to other dogs, other animal, or to people.

\_\_\_\_\_  
Signature of owner / agent

\_\_\_\_\_  
Date